

INTER

SCAPES

SPACES

PORTFOLIO

Burak Işılak

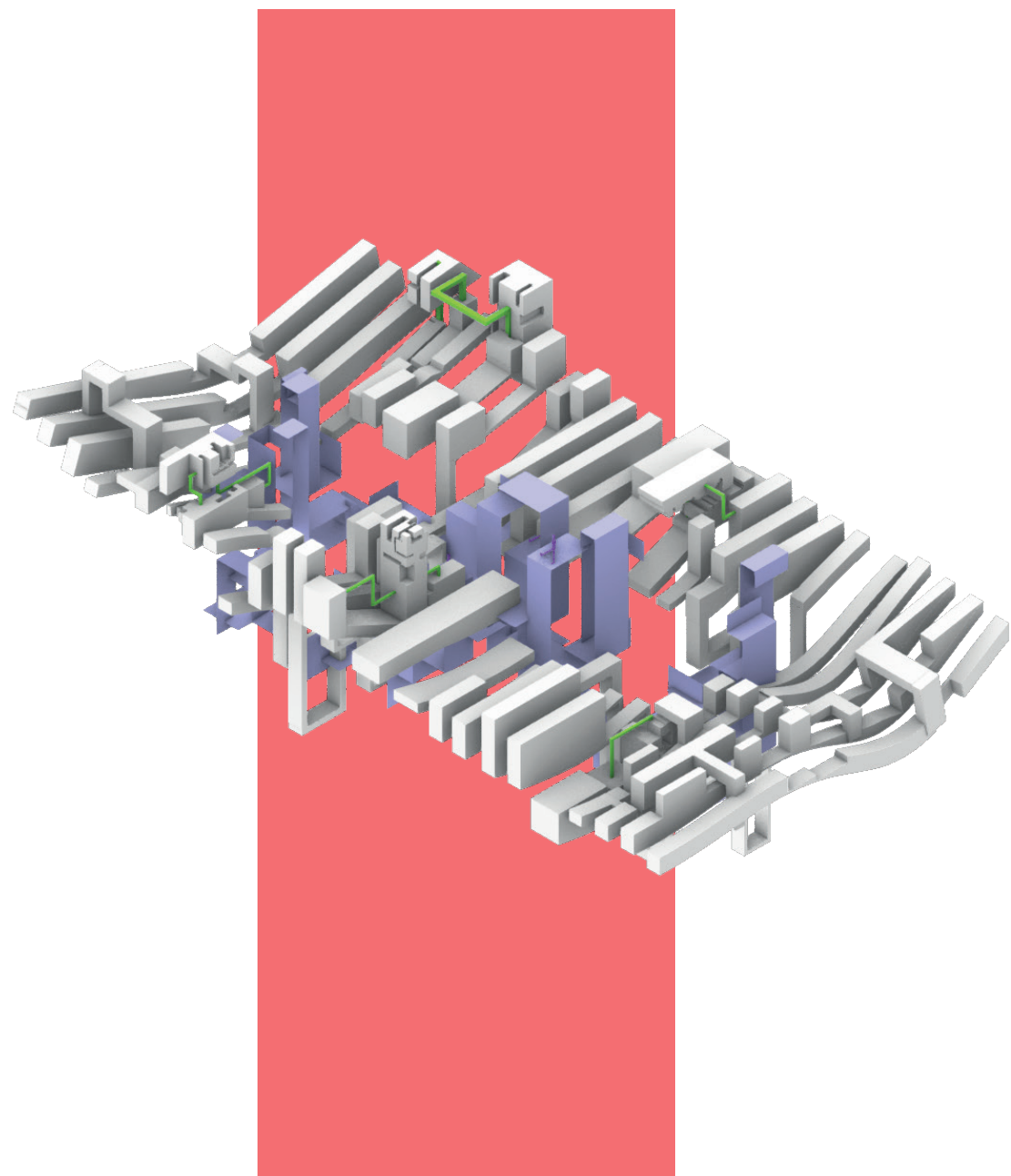

**WHAT?**

**-Layers of connections**

**HOW?**

**-Stem structure**

**-Slits**

**-Hinge(mass-line,  
mass-surface)**

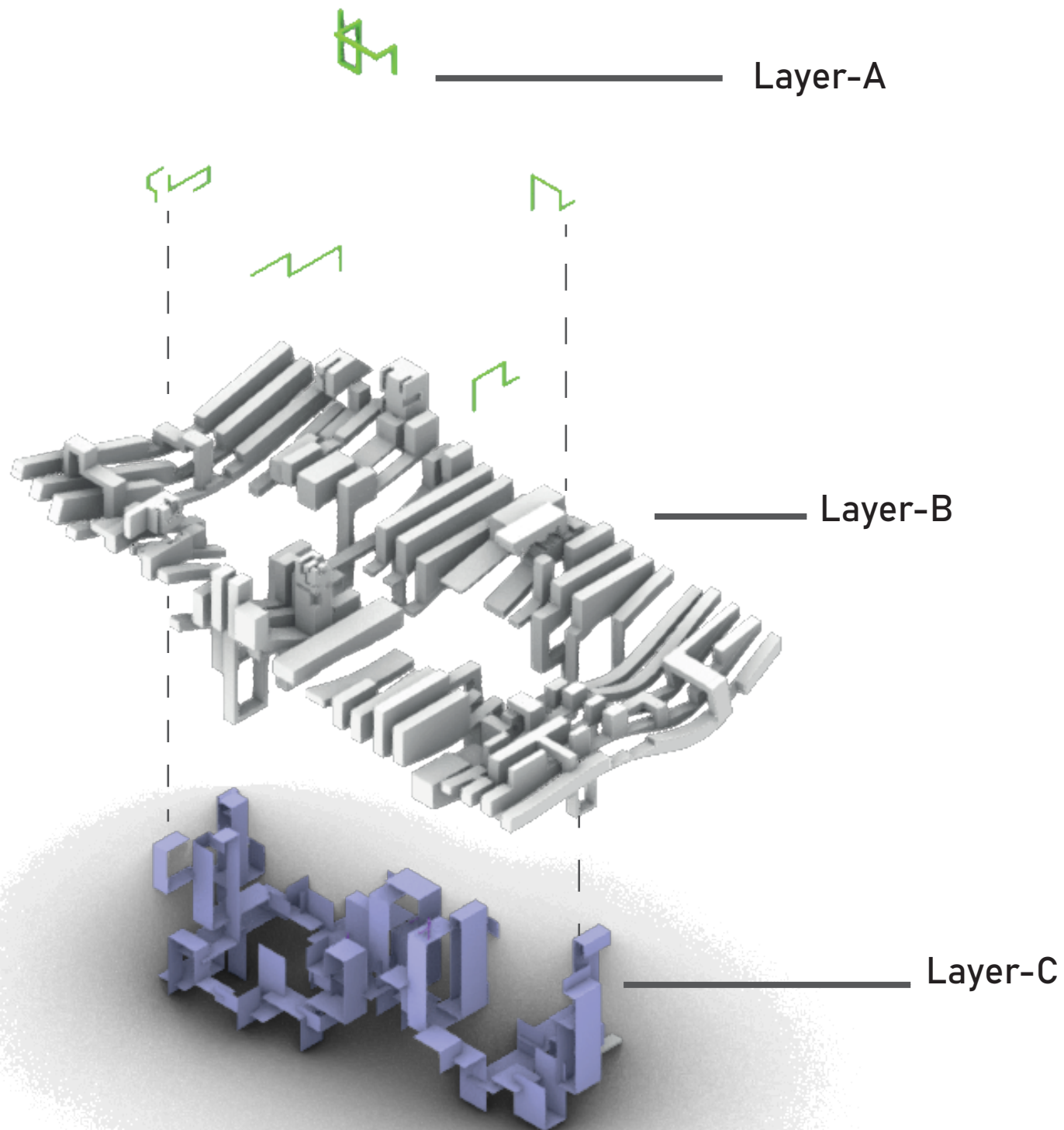

# LAYERS

## Layer-A

Composed of linear elements that hold the fractured masses for the snake nest by varying in itself in terms of complex hole structure for snake's nature. Also, these are located where the masses are fractured and the nodes occurred

## Layer-B

Created by the masses for slits in order to create varying qualities of spaces for both human and animal buddy

## Layer-C

Composed of surfaces that provides connection in-between layers by stem structure as well as where the nodes occurring its elements get elongated since the nodes are got elongated, it's difficult to reach for human scale that's why, at that point, snake gains the space to human modulator to reach the nodes called **"indirect experience"**.

Top View

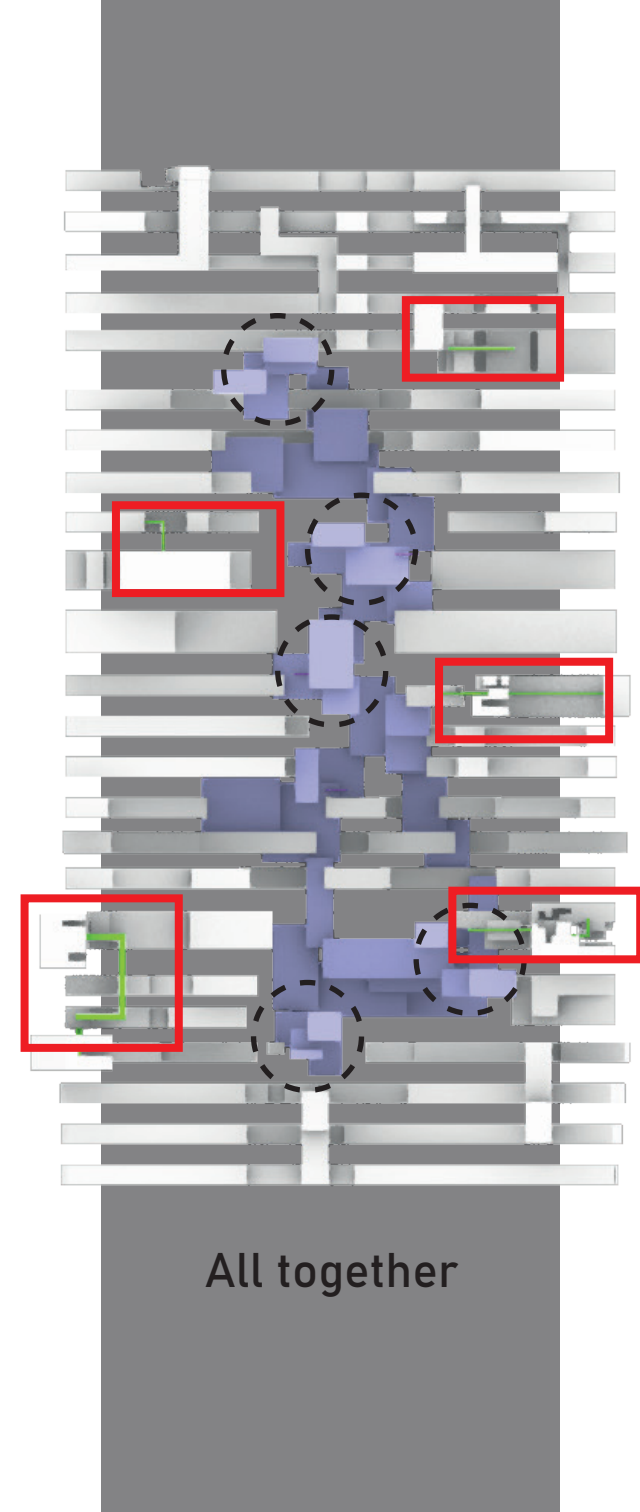
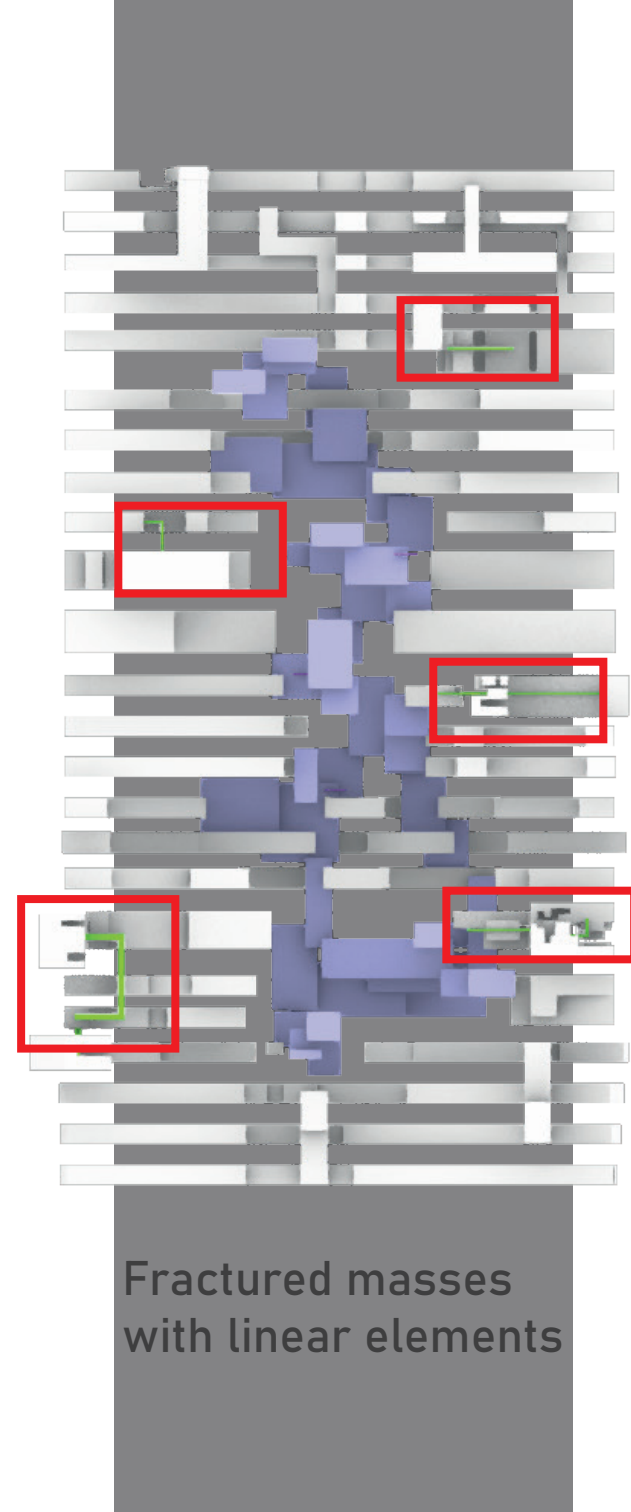
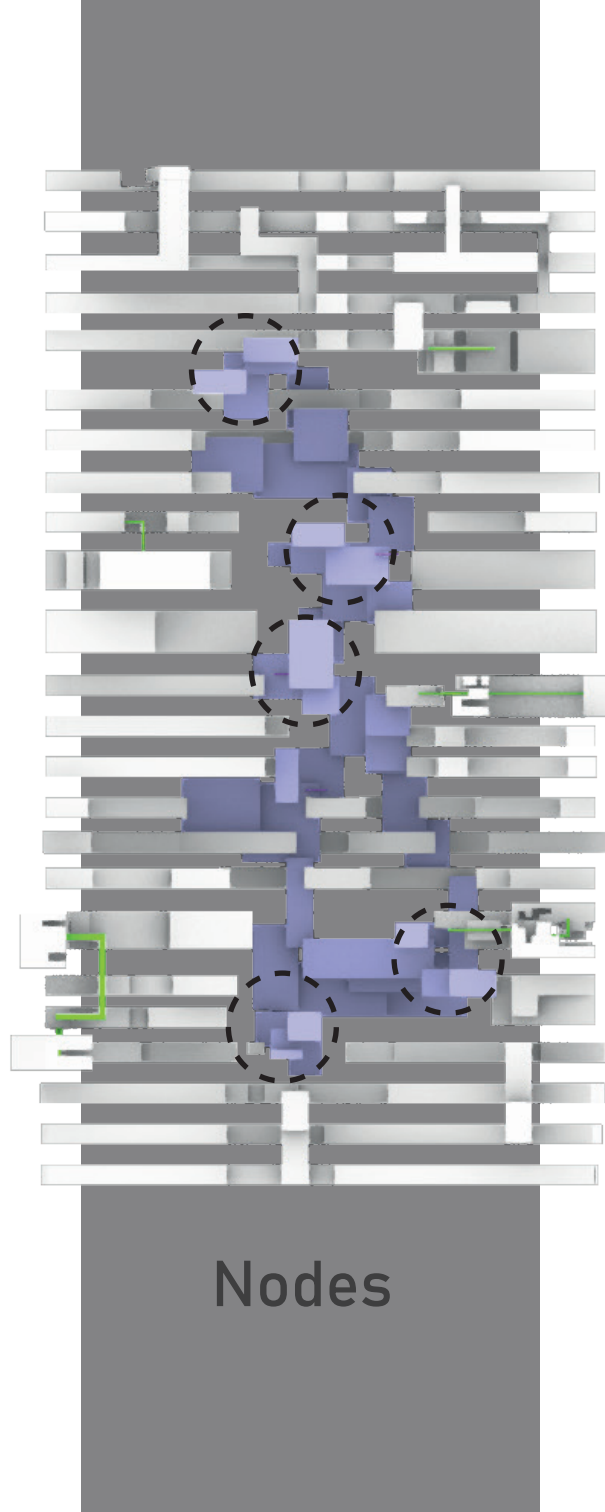

# STEM STRUCTURE

\_operation steps

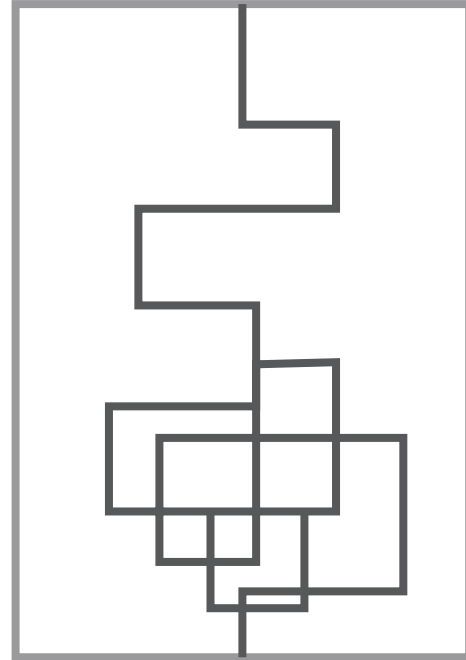
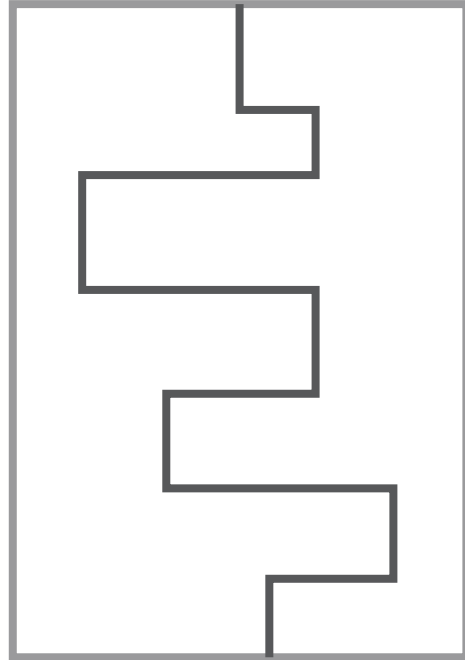
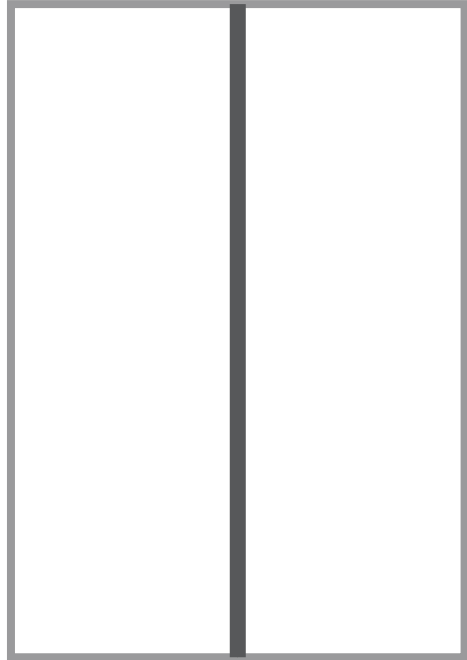

stem structure

Top View

\_interrelations with the fractured masses

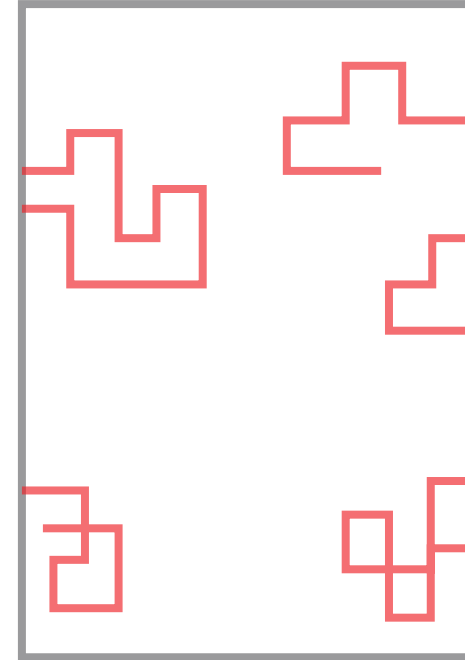

fractured masses

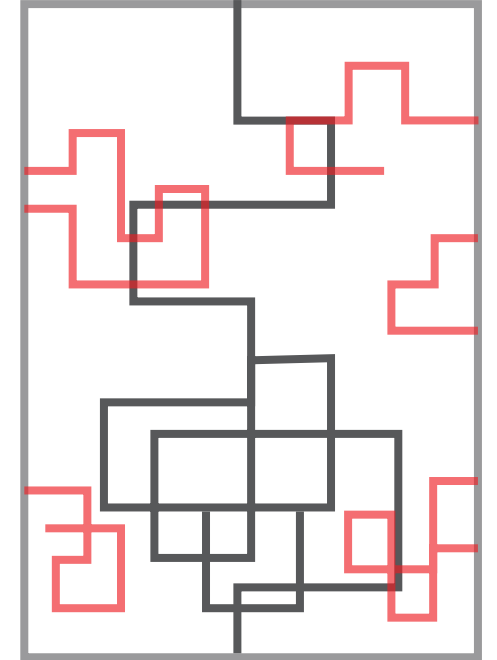

overall

Top View

# FRAMES OF SPATIAL EXPERIENCE

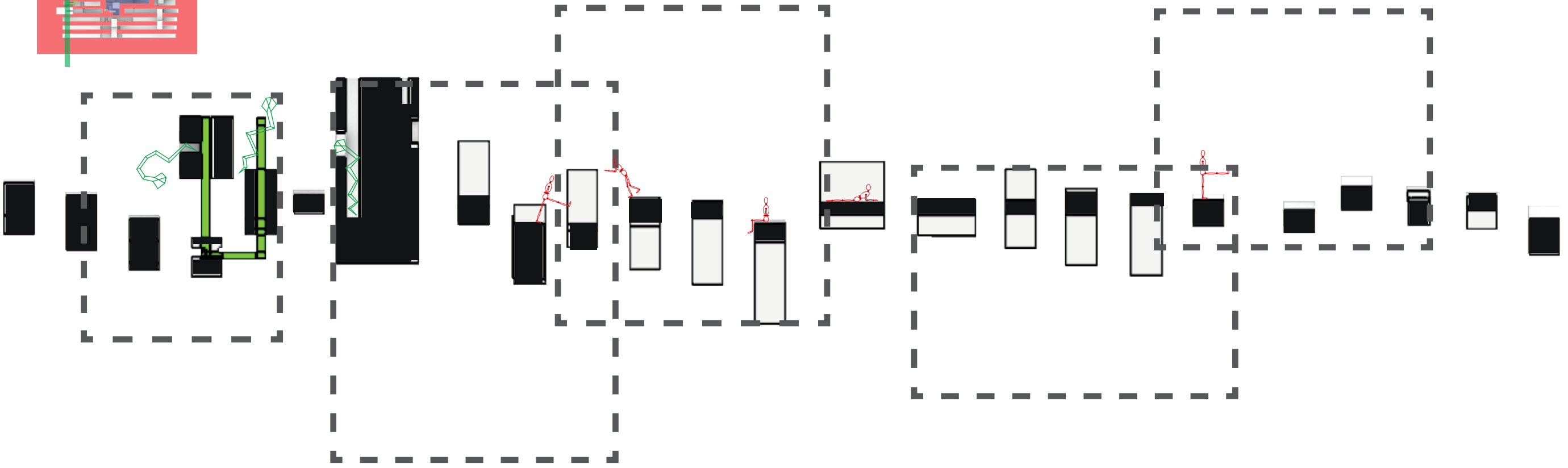
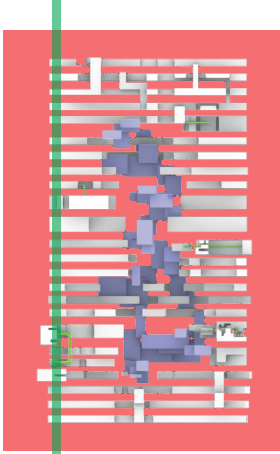

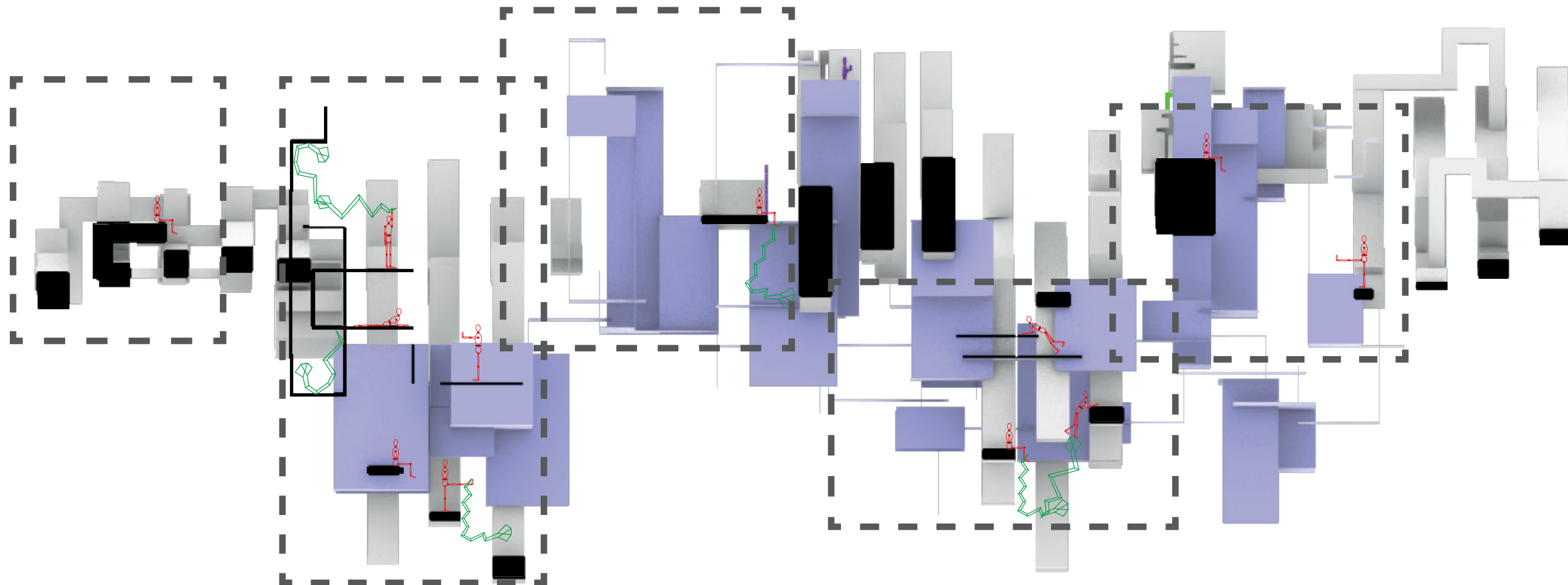
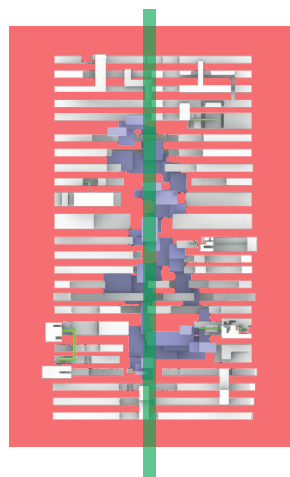

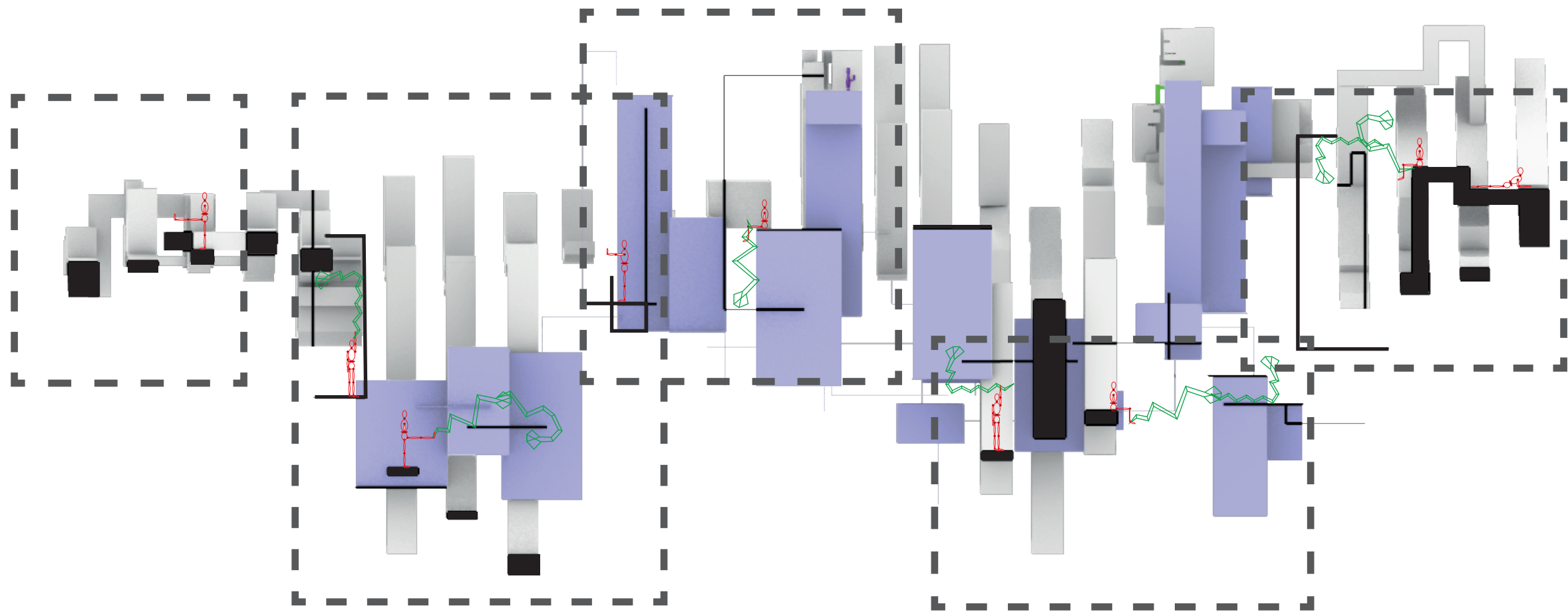
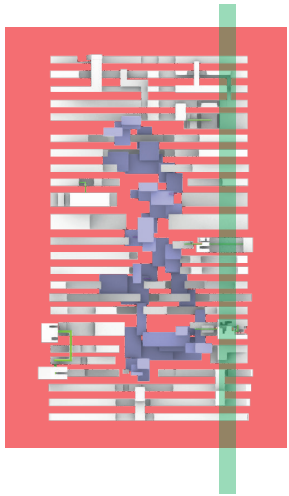



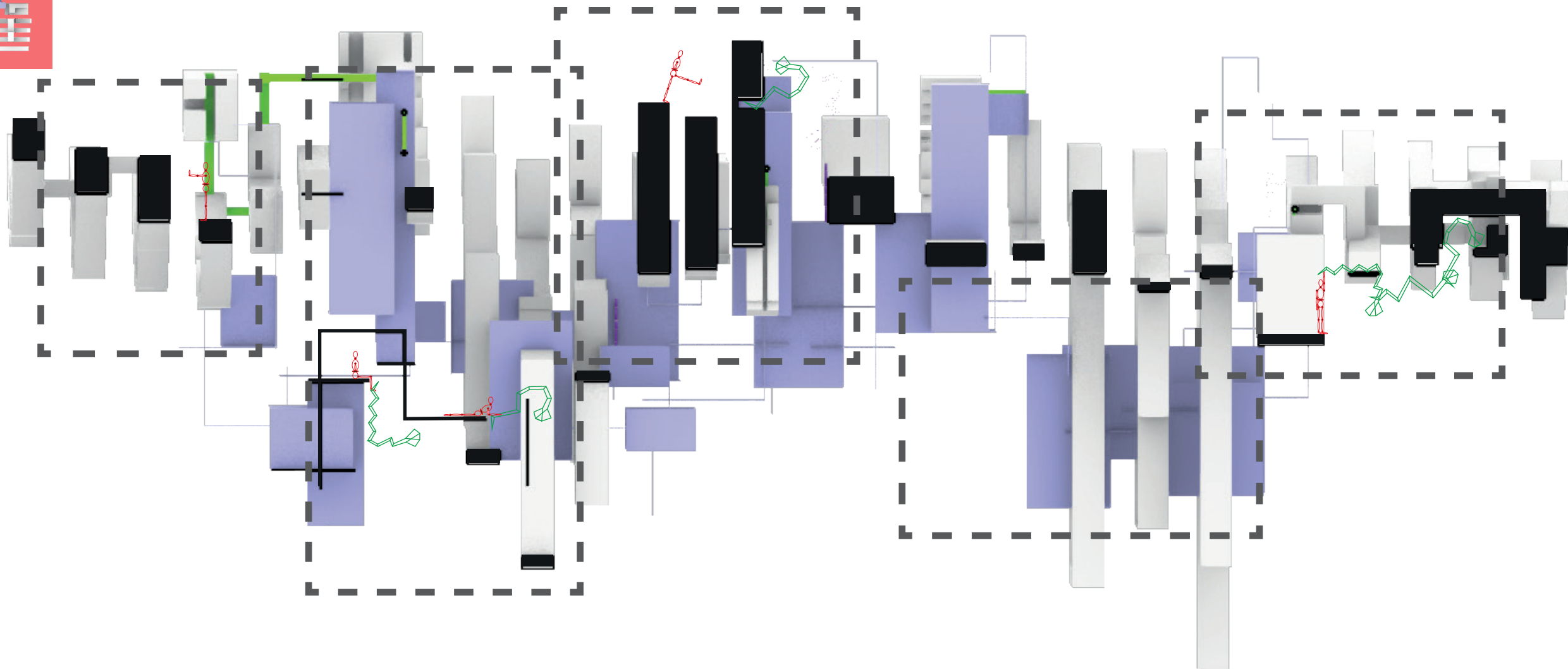
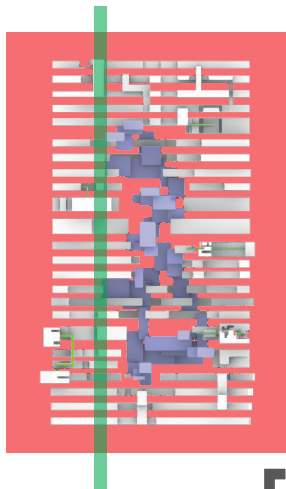

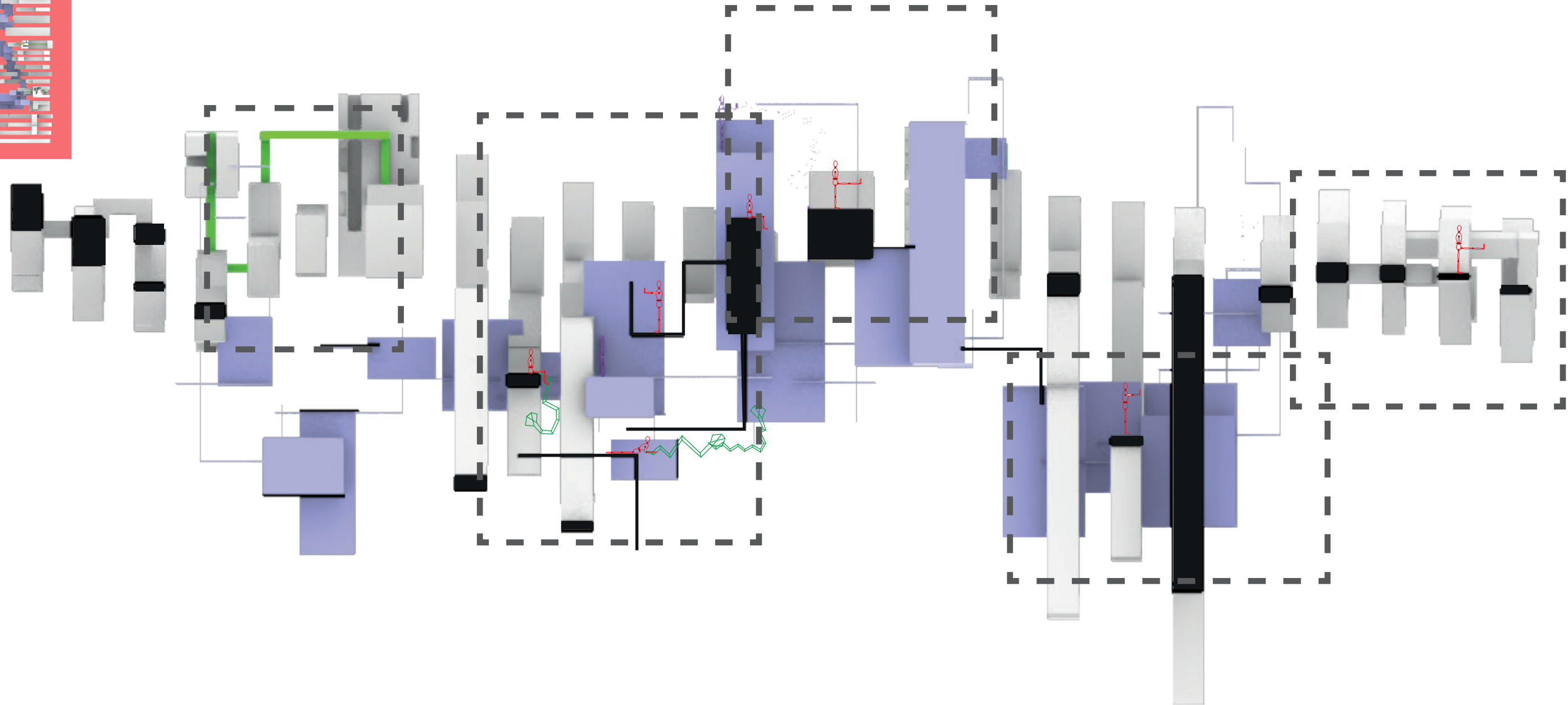
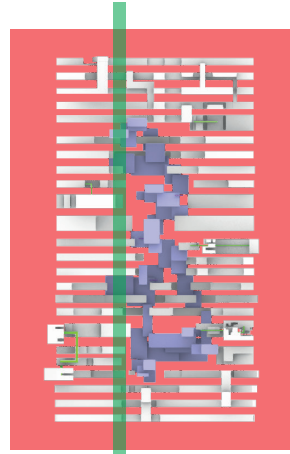

# INSTANCES FROM FIELD

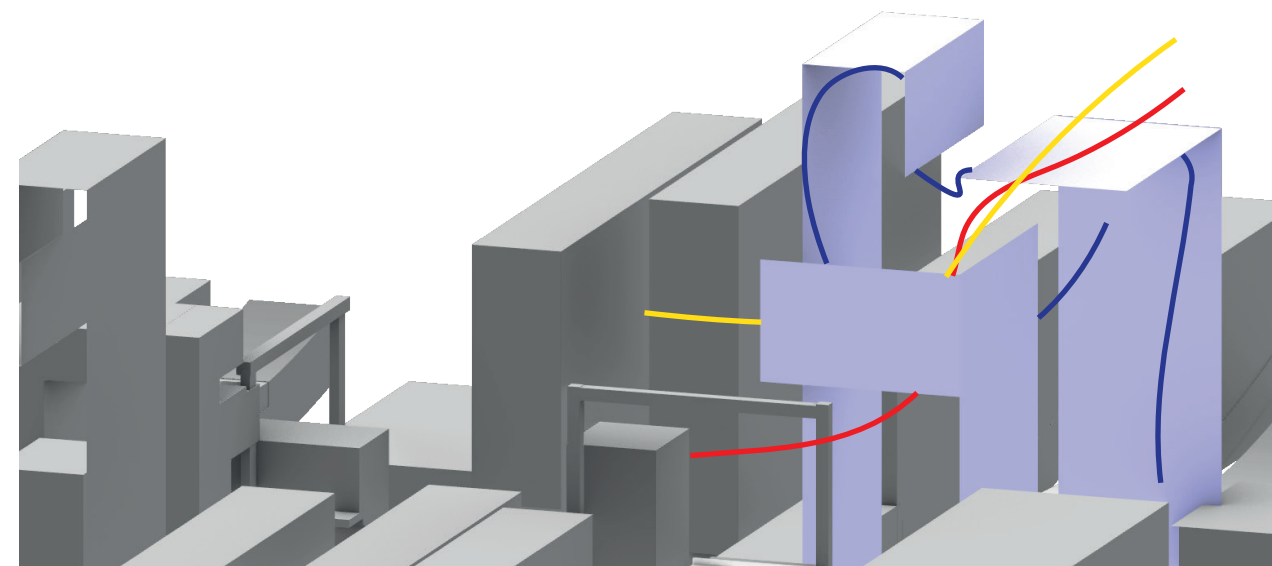
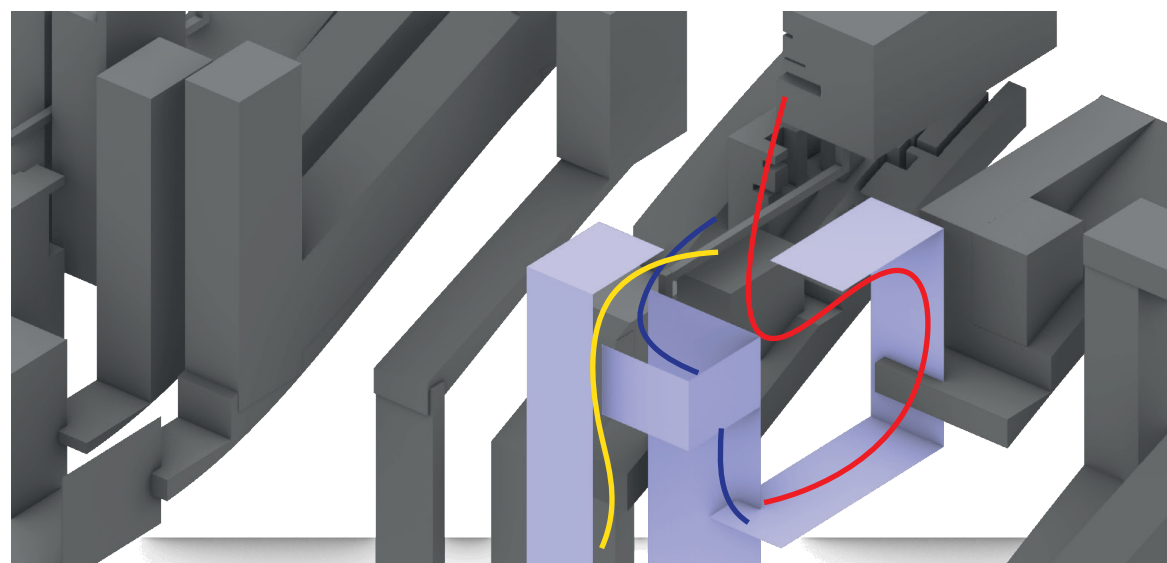
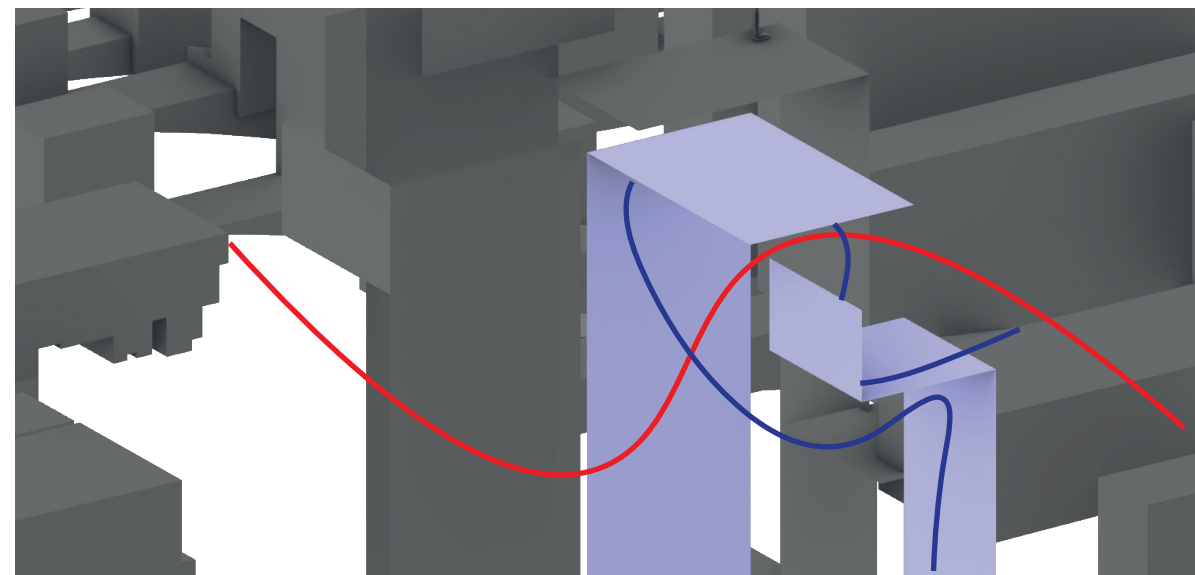
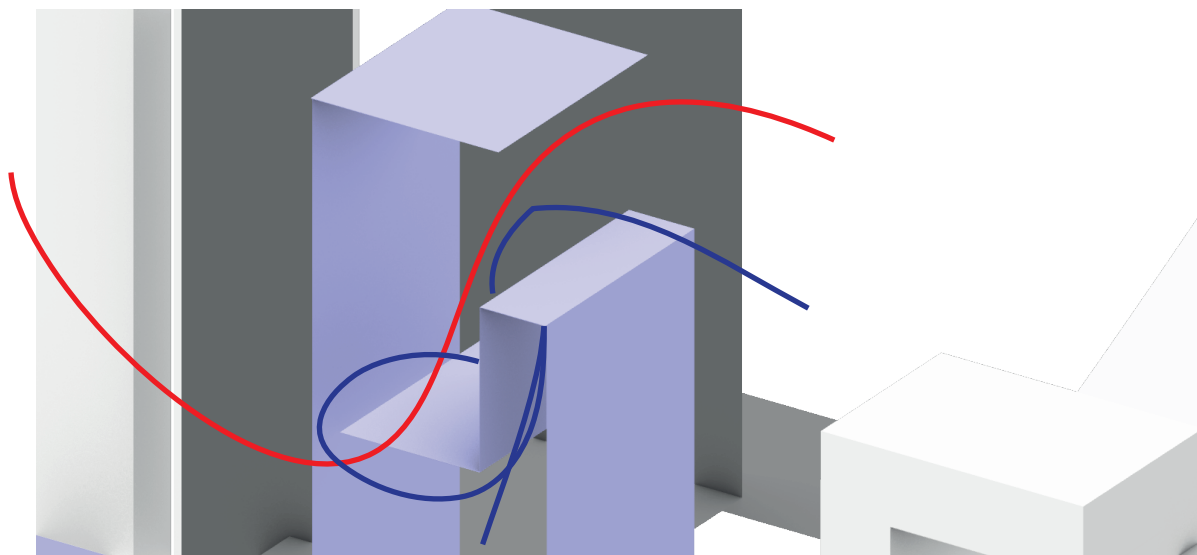

\_each line indicates one instance

